



Lilian Grove | Bilston | WV14 8YX

£900 Per Month

 **Webbs**
estate agents

Summary

Webbs Estate Agents are pleased to offer this delightful two bedroom semi-detached property for rent. Situated in a convenient location with great transport links and close to local amenities, this home offers plenty of potential for comfortable living.

The ground floor features an entrance hallway leading to a lounge and kitchen/diner. Upstairs, you'll find two generous double bedrooms and a bathroom.

Externally, there is a driveway to the front and an enclosed garden to the rear.

Key Features

- Two bedroom semi-detached property
- Good transport links and local amenities
- Two double bedrooms and a bathroom upstairs
- Convenient location
- Lounge and kitchen/diner on the ground floor
- Driveway parking and enclosed rear garden

Rooms and Dimensions

PROPERTY DETAILS:

Lounge

13'5 x 10'10 (4.09m x 3.30m)

Kitchen

13'8 x 7'10 (4.17m x 2.39m)

Bedroom One

10'5 x 10'0 (3.18m x 3.05m)

Bedroom Two

10'5 x 6'10 (3.18m x 2.08m)

Bathroom

6'5 x 5'6 (1.96m x 1.68m)

TENANCY INFORMATION & IMPORTANT NOTES





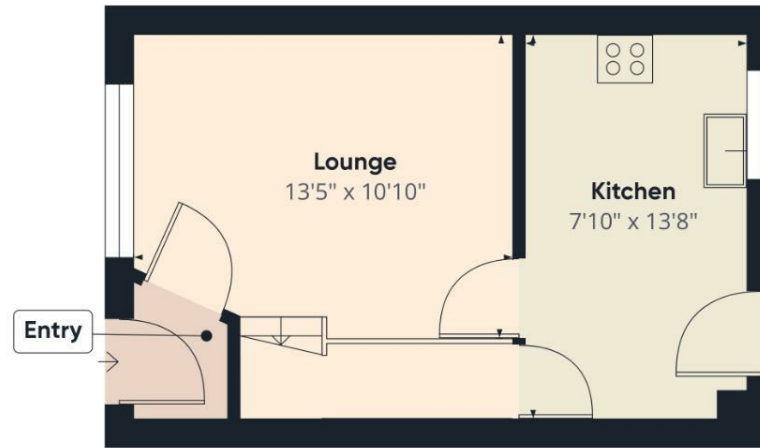

Ground Floor

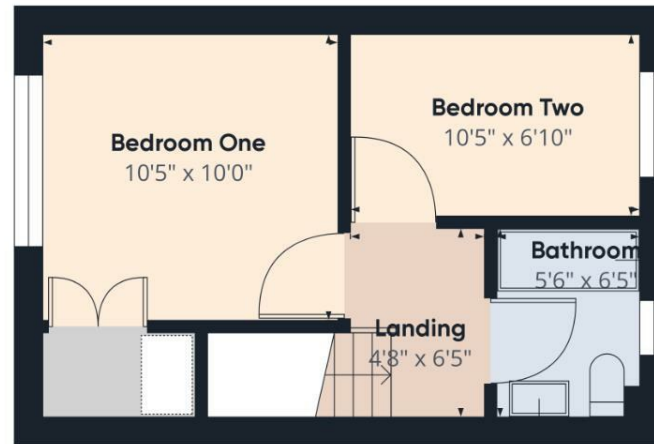

Floor 1



Approximate total area[®]
536.59 ft²

(1) Excluding balconies and terraces

While every attempt has been made to ensure accuracy, all measurements are approximate, not to scale. This floor plan is for illustrative purposes only.

Calculations are based on RICS IPMS 3C standard.

GIRAFFE 360

Webbs Estate Agents - endeavour to maintain accurate depictions of properties in Virtual Tours, Floor Plans and descriptions, however, these are intended only as a guide and purchasers must satisfy themselves by personal inspection.

